

# GENERAL ARRANGMENT DRAWING FOR CONSTRUCTION OF H.L. BRIDGE ACROSS LILAR NALLA ON CHANDELI-GHARJARA ROAD

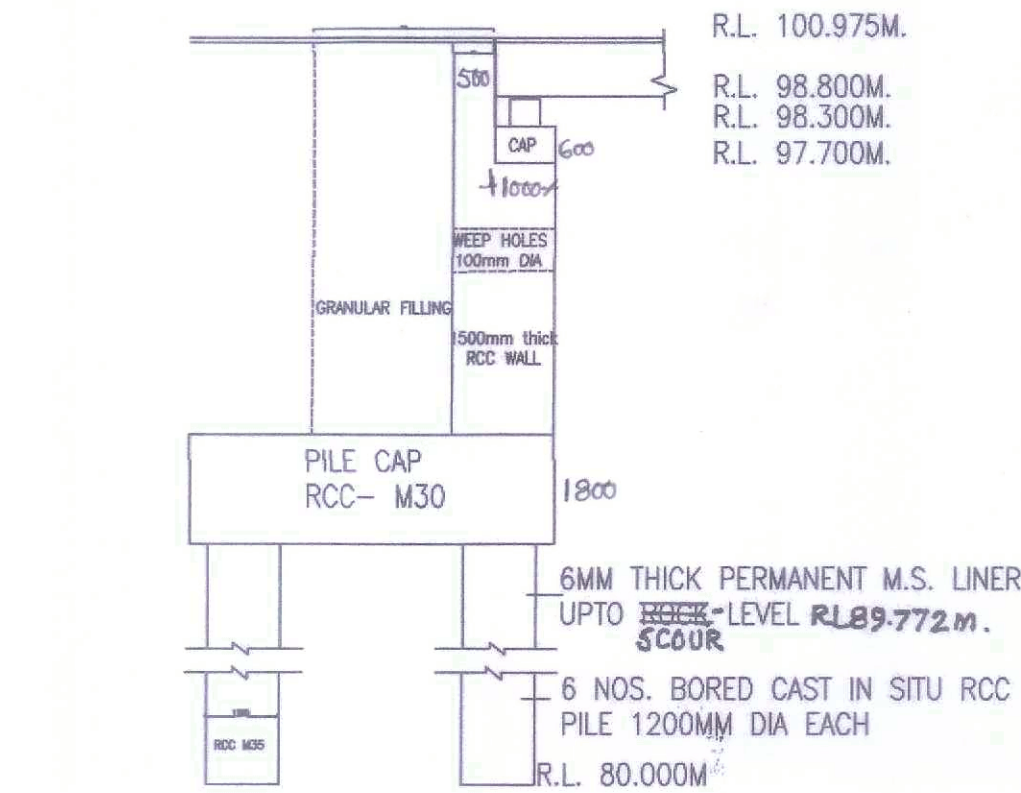

SECTIONAL ELEVATION OF ABUTMENT

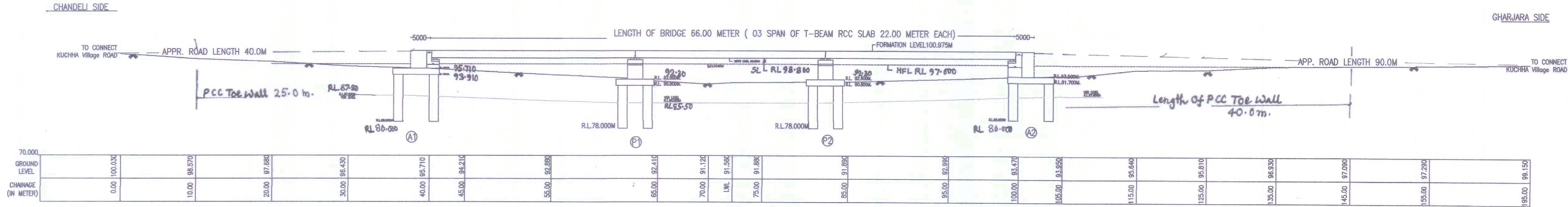
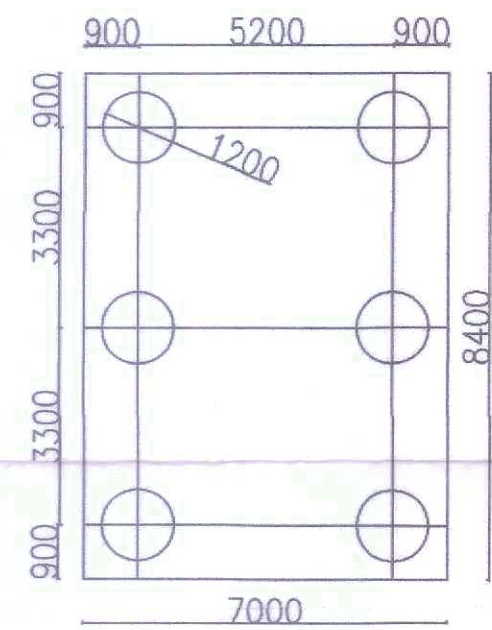

PLAN OF ABUTMENT & PILE CAP

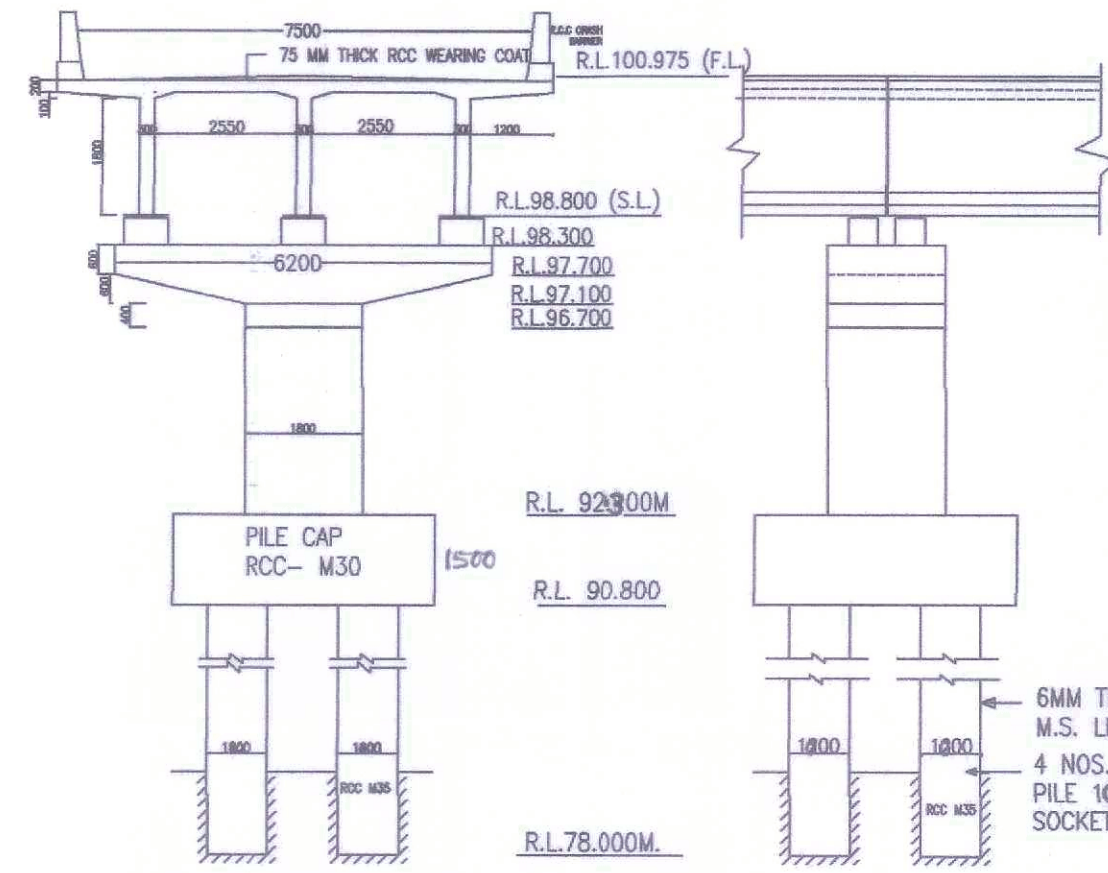

SECTIONAL ELEVATION OF PIER

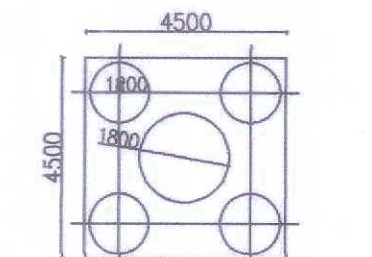

PLAN OF PIER & PILE CAP

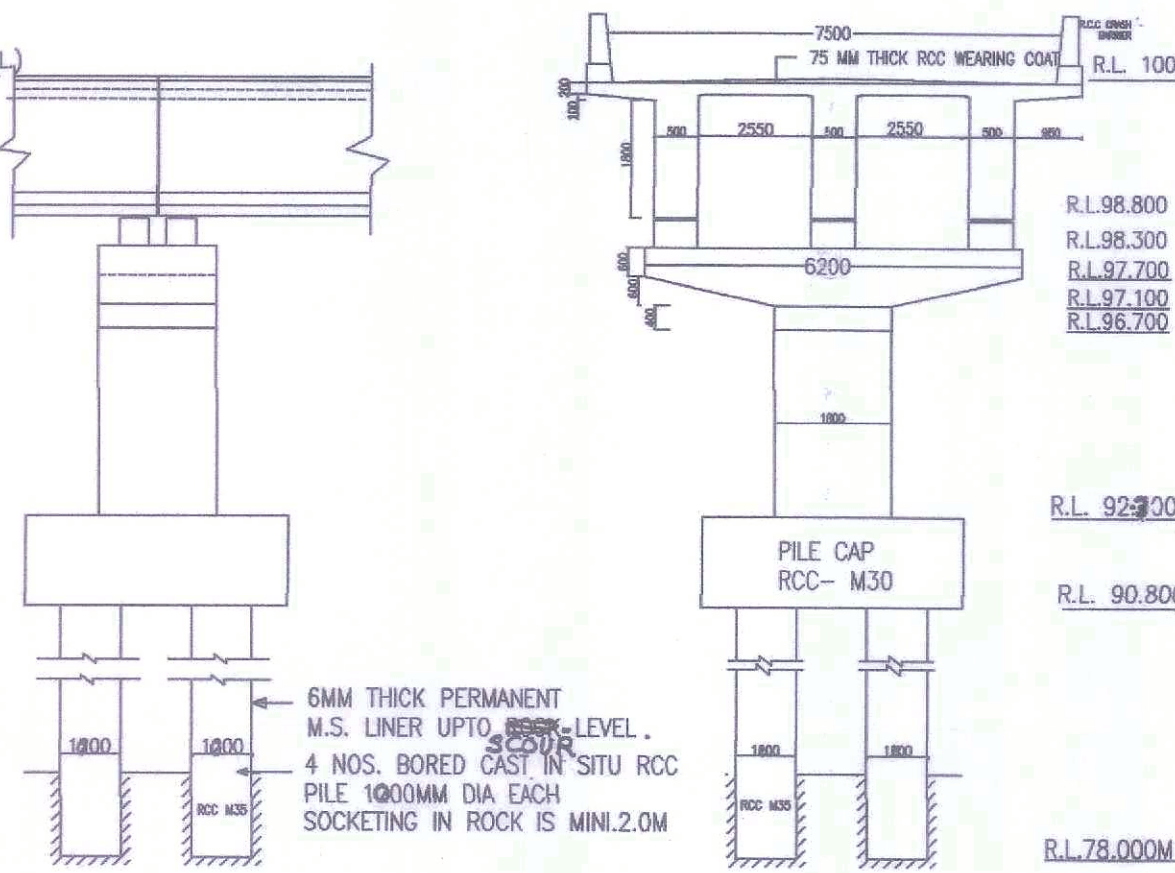

SECTIONAL ELEVATION OF PIER

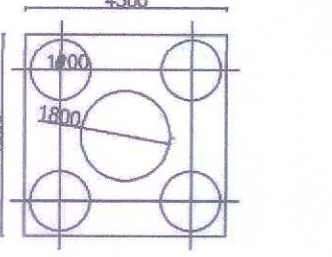

PLAN OF PIER & PILE CAP

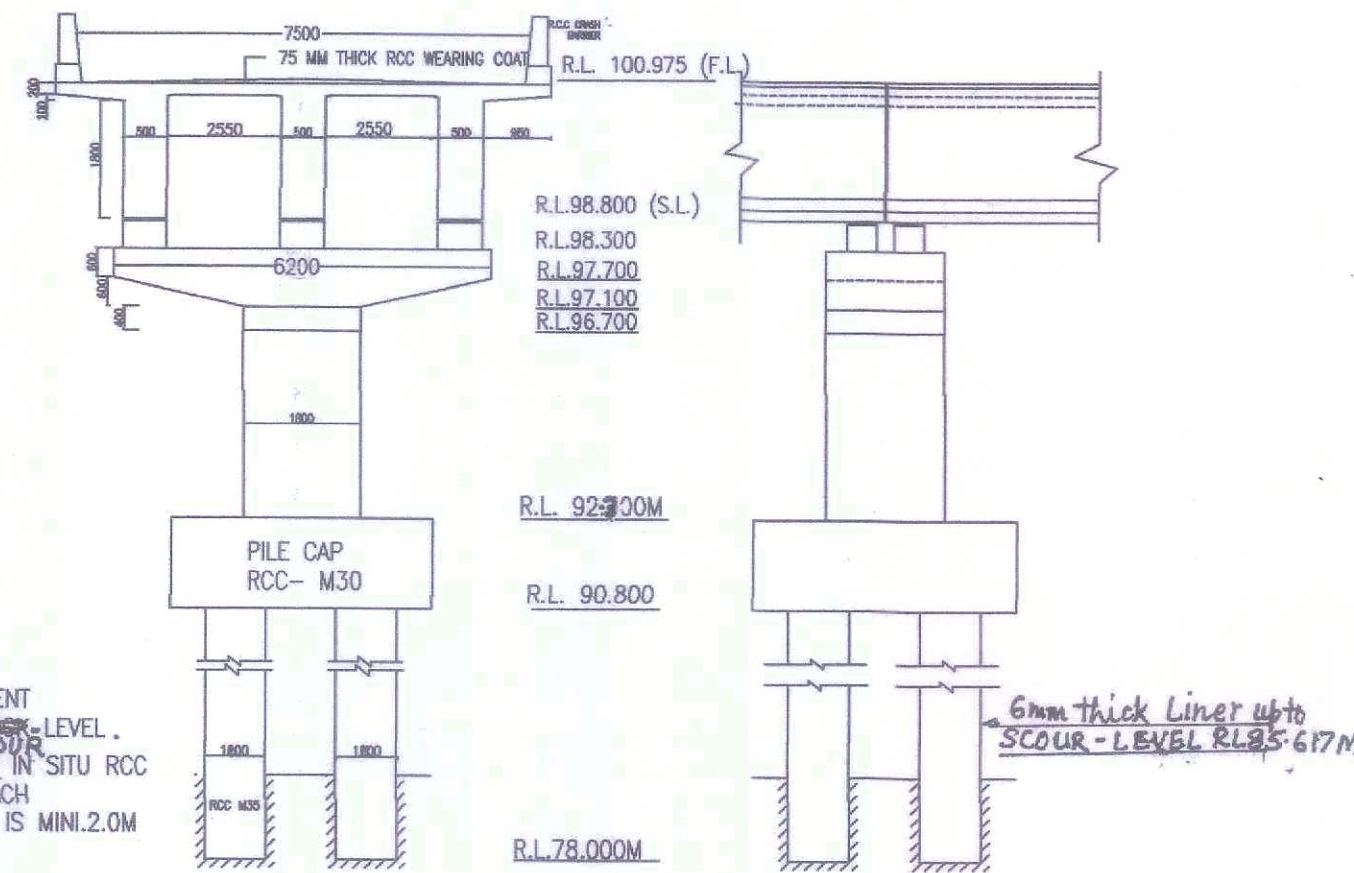

SECTIONAL ELEVATION OF PIER

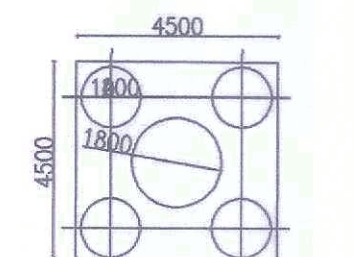

PLAN OF PIER & PILE CAP

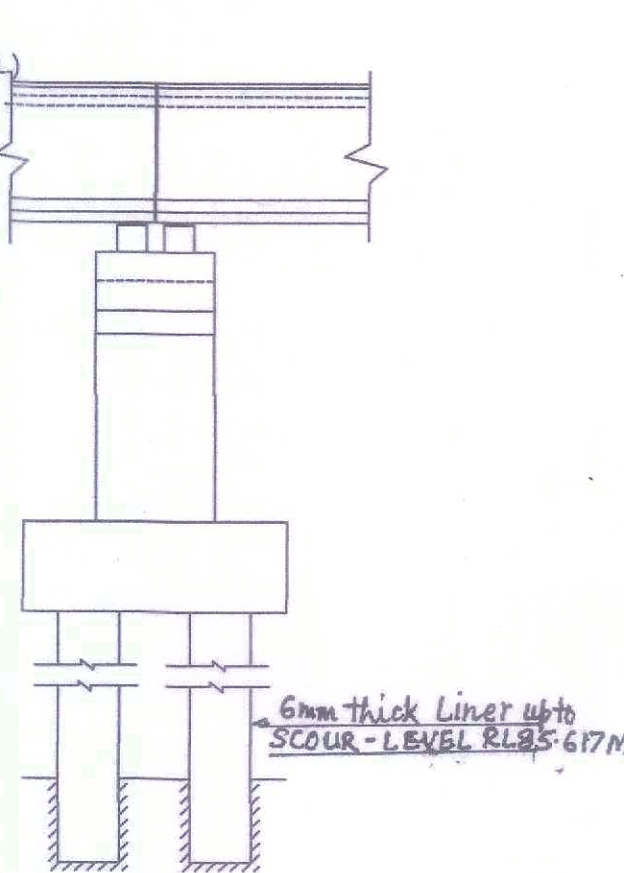

SECTIONAL ELEVATION OF PIER

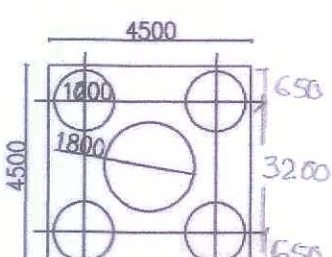

PLAN OF PIER & PILE CAP

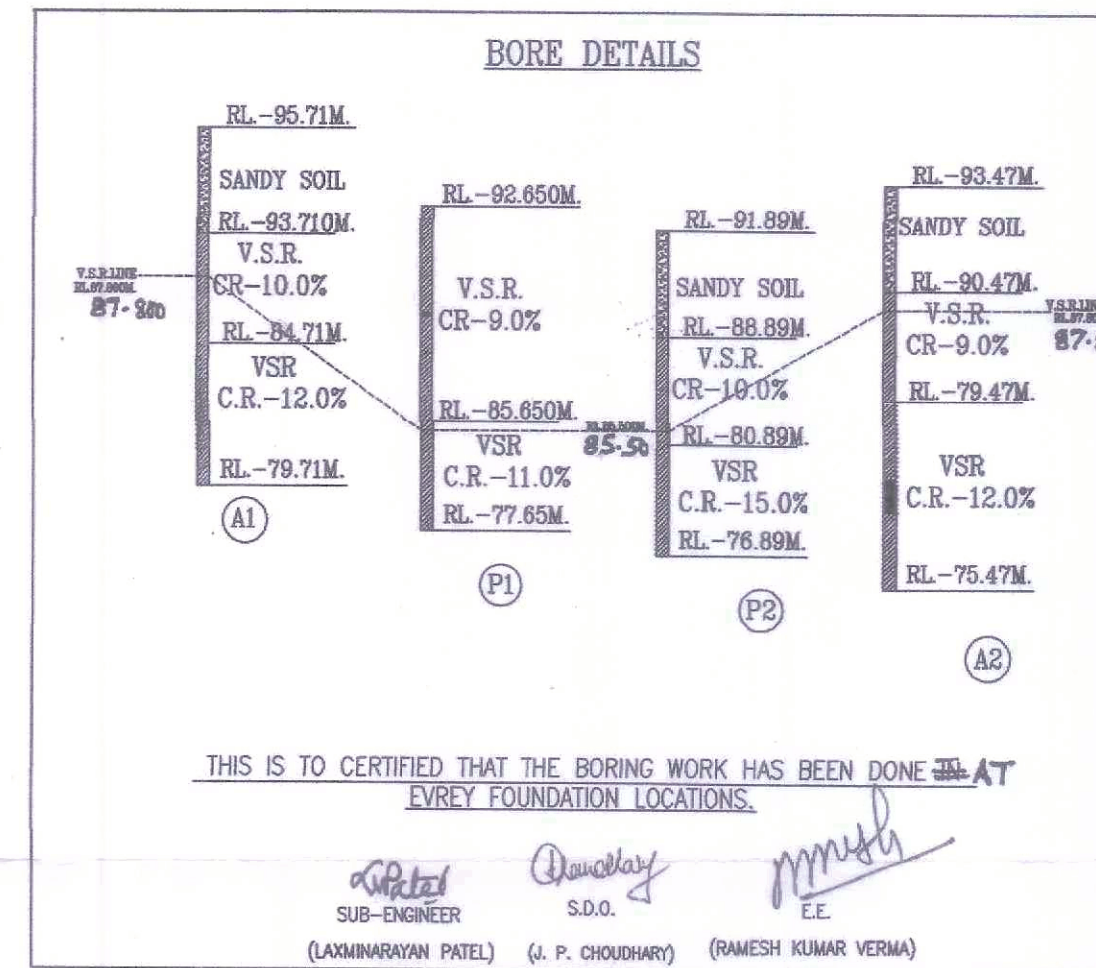

## NOTES AND SPECIFICATIONS

1	TYPE OF BRIDGE	HIGH LEVEL
2	LENGHT OF BRIDGE	66.00 METER
3	SPAN ARRANGEMENT	03 SPAN OF T- BEAM RCC SLAB 22.00 M EACH
4	FORMATION LEVEL & S.L.	R.L. 100.975 M/RL.98.800 M
5	OVER ALL WIDTH	8.40 M
6	CLEAR ROAD WAY	7.50 M
7	CATCHMENT AREA	77.25 SQ. KM.
8	DESIGN DISCHARGE	496.88 CUMECs
9	DESIGN VELOCITY	1.59 M/SEC.
10	NORMAL SCOUR DEPTH	5.690 M, PIER:- RL.85.617 & ABUT:- RL.89.772M
11	H.F.L.	RL.97.000M
12	L.W.L / L.B.L.	RL.91.560M /R.L. 91.120 M
13	TYPE OF FOUNDATION	
	A. PIER	PILE
	B. ABUTMENT	PILE
14	FOUNDATION LEVEL	
	A. PIER	(P1,P2)- R.L. 78.000M
	B. ABUTMENT (A1 & A2)	A1-R.L. 80.000M, A2- R.L.80.000M
15	TYPE OF SUB STRUCTURE	
	A. PIER	RCC SOLID CIRCULAR TYPE
	B. ABUTMENT	RCC WALL TYPE
16	TYPE OF BEARING	ELASTOMERIC NEOPRENE BEARING
17	TYPE OF SUPERSTRUCTURE	T -BEAM RCC DECK SLAB
18	WEARING COAT & KERB	RCC WEARING COAT AS PER STD. DRG. OF MORT&H.
19	RAILING	R.C.C. CRASH BARRIER.
20	EXPANSION JOINT AS PER	STRIP SEAL EXPANSION JOINT
21	APPROACH SLAB	AS PER STRUCTURAL DRG
22	WATER SPOUT	AS PER STD DRAWING OF MORT & H
23	NAME PLATE	AS PER STD DRAWING
24	DESIGN LOADING	SINGLE LANE:- OF IRC CLASS 70-R LOADING OR TWO LANES:- OF CLASS- A AS SPECIFIED IN IRC-6-2017 WHICH EVER PRODUCES SEVERE EFFECT(S).
25	S.B.C.	40T/ SQM
26	THIS DRG IS ONLY FOR ESTIMATE PURPOSE PLEASE REFER SEPERATE DRG FOR EXECUTION	
27	ALL DIMENSIONS ARE IN MM & RL ARE IN METER OTHERWISE SPECIFIED.	

APPROVED BY	C.E.	<i>Chrs</i> M.L. URAON <i>17/12/24</i>
	S.E.	<del><i>SPK</i></del> M.L. UIKEY
CHECKED BY	E.E.	<i>mmsh</i> RAMESH KUMAR VERMA
	S.D.O.	<i>Chandray</i> J.P. CHOUDHARY
<i>UnPacked</i> <i>(L.N. Patel)</i>	C.G. P.W.D. BRIDGE CONSTRUCTION DIVISION - RAIGARH	
	G.A.D. FOR CONSTRUCTION OF H.L.BRIDGE ACROSS LILAR NALLA ON CHANDELI-GHARJARA ROAD	
DRAWN BY		
DRAWING NO. -		